

Analysis of the Characteristics of Academy Garden Construction in Ningbo Area during the Ming and Qing Dynasties

Jiajia Jiang^{1,a}, Yile Liu^{1,b}, Qingyang Chen^{1,c,*}

¹College of Design Art and Architecture, Zhejiang Wanli University, Ningbo, China

^ajiangjiajia0520@163.com, ^bkarroy1023@163.com, ^cchenqingyang@zwu.edu.cn

*Corresponding author

Keywords: Landscape Architecture, Academy Garden, Ningbo Environmental Landscape, Cultural Connotation

Abstract: Academies have always been places for ancient Chinese scholars to collect books, offer sacrifices and conduct academic research. Their garden environment is also an important place for scholars and literati to cultivate their character and refine their nature. The Ningbo area has a flourishing literary atmosphere and occupies an extremely important position in the development process of academy gardens in Zhejiang. During the Ming and Qing dynasties, the academy gardens in Ningbo, while inheriting the garden-making techniques of traditional gardens in the Jiangnan region, were influenced by popular academic thoughts such as the Yangming School and the Zhe Dong School, as well as the geographical and humanistic environment, presenting distinct regional characteristics. This article takes the generation background and garden-making characteristics of the academy gardens in the Ningbo area during the Ming and Qing dynasties as the research object, attempts to sort out the development context of the traditional garden culture in Ningbo during this period, and provides theoretical support for the protection of the material culture and the inheritance of the spiritual connotation of the gardens in this area.

1. Introduction

The Ningbo area has long had the fine tradition of passing on farming and reading to the family and emphasizing education and promoting learning. During the Ming and Qing dynasties, Wang Yangming's School of Mind and the Zhe Dong School shone brightly. The ideas proposed by Wang Shouren and Huang Zongxi, such as "the unity of knowledge and action", "applying knowledge to practical use", and "both industry and commerce are fundamental", were widely spread. During this period, there were a large number of academies in Ningbo, with a free academic atmosphere and diverse academic pursuits. The construction of academy gardens also reached its peak. While inheriting the traditional Jiangnan garden techniques, certain innovations were made in terms of functions and construction methods, forming a unique style. On the one hand, while the academy garden meets the educational and practical functional requirements such as lecturing, sacrificial ceremonies, book collection and recreation, its spatial layout and landscape details reflect the intrinsic

fit with the academic and cultural spirit of the region. On the other hand, influenced by the local Marine culture, trade culture and traditional folk customs, it also bears profound geographical and humanistic imprints.

2. Create the background

2.1. Origin and Development

During the Dazhong period of the Tang Dynasty, the first records of academy gardens in the Ningbo area were made, with Derun Academy and Yingxi Academy as representatives, which became important places for academic education and research at that time. These academies are mostly far away from the hustle and bustle of the world to create a quiet learning environment and set up academic fields to maintain the operating funds. Early academy gardens not only served as places for storing and cultivating books, but also demonstrated different attachment patterns: some academies relied on academic fields and were self-sufficient, showcasing a strong culture of farming and reading. Some are located in mountain and forest resorts or by the lakeside, blending in with the natural landscape. The development of the academy gardens in Ningbo during the Tang Dynasty reflected the economic and cultural prosperity at that time. It was influenced by the Confucian view of mountains and waters and laid the foundation for the development of academy gardens in later generations.

With the southward shift of the economic center and the Song Dynasty, cultural and educational activities in the Ningbo area developed rapidly during the Northern and Southern Song Dynasties, and the number and scale of academies and gardens increased significantly^[1]. The layout of gardens is becoming increasingly refined and begins to focus on artificial construction. For instance, the Taoyuan Academy of the Northern Song Dynasty, as recorded in Quan Zuwang's "Jiaoqi Pavilion Compilation" : "The Taoyuan Academy was formerly located at the end of the forest in Wuling to the west of the city, which was the ancient hall for Mr. Wang to study." The courtyard is adjacent to the riverbank. Relying on the existing mountain and water terrain, it is ingeniously and artificially laid out, forming a pattern that combines architectural layout with garden landscape^[2]. The architectural style of the Song Dynasty was simple and elegant, often featuring wooden structures that complemented the surrounding water bodies, creating a layout of "water courtyards" or "water pavilions". This not only met practical needs but also added a touch of refined artistic conception.

During the Chenghua period of the Ming Dynasty, with the relaxation of the policy of "non-institutional academies" in the early Ming Dynasty, educators such as Wang Yangming and Zhan Ruoshui widely opened academies in the countryside to promote Neo-Confucianism, and the doctrine of "applying learning to practical use" was widely spread in the Ningbo area. During this period, the academy developed a trend of free teaching, and the environment gradually expanded from remote mountain forests to residences, gardens, temples and other places^[3]. The urban and rural residence garden-style academy garden has become the mainstream form, emphasizing the creation of an elegant educational environment in the daily living environment. Furthermore, due to Ningbo's special status as an official port for foreign exchanges during the Ming Dynasty, the academy gardens also clearly incorporated elements of Marine culture.

The Qing Dynasty was an important period for the popularization and transformation of academies. Academy education was incorporated into the official education system, and the number of academies in Ningbo increased significantly, with a wide distribution. According to the "Dictionary of Chinese Academies", there were as many as 57 government-run academies in urban areas during the Qing Dynasty. Huang Zongxi, a representative figure of the Zhe Dong School, once gave lectures at the Yongshang Witness Academy. His advocated concepts of "applying knowledge to practical use" and "both industry and commerce are fundamental" promoted the transformation of Wang

Yangming's studies towards practical learning. Influenced by official and regional Confucianism, the spatial layout of the academy gardens tended to be regular, with a more rigorous layout along the central axis. Water bodies, vegetation, and buildings were all distributed in sequence. Meanwhile, the academy still attaches great importance to the creation of gardens that blend scenes and emotions. For instance, Zong Yuanhan, the governor of Ningbo, built the "Biezhi Academy" on the Bamboo island of Moon Lake. The secluded and elegant small island adds more natural beauty to the academy.

After Ningbo was opened as a trading port, the influence of Western learning increased day by day. Compared with other regions, it accepted Western educational concepts earlier and gave rise to new educational institutions such as church academies and Overseas Chinese academies^[4]. At the end of the Qing Dynasty, with the abolition of the imperial examination system, the academy system was impacted. The Qing court ordered that "academies in provincial capitals, prefectures and counties across the country be transformed into schools", and the form of academies was completed. Some Ningbo academies, influenced by the Western educational model, have seen their architectural styles tend to be Westernized. Church-style buildings are quite common, and the garden layout also tends to be simple and symmetrical. A large number of lawns and shrubs replace trees. The overall appearance reflects the cultural transformation of Ningbo academy gardens during this period.

2.2. Generating Factors

The formation and development of academy gardens in the Ningbo area cannot be separated from both material and spiritual factors^[5]. As a famous historical and cultural city, Ningbo has long been renowned as a "land of culture and education". Academies not only undertake educational functions but also serve as research and dissemination venues for academic schools such as the Yangming School and the Zhe Dong School. The gathering of scholars and literati led to a sharp increase in the number of academies, and many academy gardens were also constructed under the supervision of scholars. As a place for academic exchange and ideological collision, its design concept of harmonious coexistence and the cultural atmosphere of the open lecture hall have also been deeply influenced by these philosophical thoughts.

Ningbo's unique natural environment and the prosperity of its economy and culture have provided a solid material guarantee for the development of academy gardens^[6]. Located on the coast of the East China Sea, with the Siming Mountain to the west, the area is crisscrossed by a dense network of rivers and has a well-developed water system. The geographical condition of mountains and water interdependent not only endows the Academy garden with unique mountain and forest beauty but also provides rich natural elements for garden design. The subtropical monsoon climate has given rise to a wide variety of vegetation. Evergreen broad-leaved trees such as camphor trees and osmanthus trees are widely used in gardens, and aquatic plants like lotus and reed are also commonly found in the water features of academies. These plants not only enhance the ornamental value, but also embody the moral pursuits and spiritual symbols of scholars and literati.

Meanwhile, Marine culture endowed the literati of Ningbo with a more open mind and an innovative spirit^[7]. The long-term overseas trade exchanges made the concept that "industry and commerce are both fundamental" deeply rooted in people's hearts, promoting the prosperity of the local economy and enabling Ningbo to rapidly rise as a cultural highland after the Song Dynasty. Since ancient times, Ningbo has had the tradition of donating funds to build schools. The government and social celebrities have provided more material guarantees for the construction and maintenance of academies and gardens. The academy not only served as a place for educational research but also became a platform for merchants and scholars to showcase their wealth and express their aspirations^[8]. With the government's lenient policies on overseas trade and continuous investment in education, the number of academies has increased significantly. The cultivation of talents has given

back to society, promoting a virtuous cycle of economy and culture, and further consolidating Ningbo's cultural status in ancient China.

3. Create characteristics

3.1. Site Selection Characteristics of Ningbo Academy Gardens

During the Tang and Song dynasties, the academy gardens in Ningbo were influenced by multiple cultures. The site selection not only emphasized the natural environment but also the cultural origin. In terms of environmental selection, the mountain and forest-type academy gardens are simple and serene^[9]. For instance, the Longshan Academy in Yuyao is located on the southern slope of Longquan Mountain, surrounded by mountains and water, with lush forests, which perfectly embodies the artistic conception of "the integration of self and nature, and the unity of man and nature" (Figure 1). Such site selection not only provides students with a quiet learning environment, but also aligns with the pursuit of seclusion and retreat in Confucian culture.

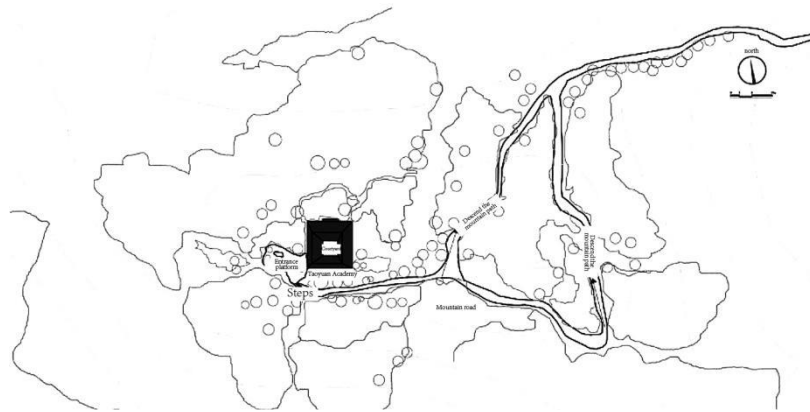

Figure 1 Map of the orientation of Taoyuan Academy

During the Ming Dynasty, due to institutional adjustments, the number of government-run academies decreased while private ones flourished. Some academy gardens were located on rural streets or in one's own residence^[10]. Urban and rural courtyard-style academy gardens gradually replaced mountain-forest-style academies, and the construction of academies became more popular. During this period, the academy was no longer confined to being secluded and secluded. Instead, it made use of natural landscapes and planted flowers and trees in the courtyards. For instance, Huang Runyu established the Nanshan Academy in his hometown residence, standing by the rice fields and streams. For over two decades, he imparted Neo-Confucianism, demonstrating the flexible location selection method of academies during this period.

During the Qing Dynasty, academies became an important means of popularizing education. Government-run academies rose while private ones declined. The location of academies was often chosen in the bustling areas of towns. Urban academies were mostly funded by local officials and located on major water or land transportation routes to facilitate the movement of scholars, but still emphasized the creation of natural landscapes. For instance, Yongshang Witness Academy is located on the north bank of the Guanjiang River, with its shimmering water, complementing the water-friendly features of Ningbo's water town residences. Its owner, Wan Bangfu, wrote in his retirement poem: "Under the moonlit pine window, before the wild ferry, I don my straw coat and bamboo hat to fish by the green shade." These academies were built along the water, fully demonstrating the pursuit of natural landscapes in Ningbo's academy gardens and the ideal environmental view of Confucian scholars. In addition, the convenient transportation conditions have promoted academic

exchanges and cultural dissemination, enabling the academy to play a greater role in the education system.

During the late Qing Dynasty, with the introduction of Western culture, the introduction of Western culture further influenced the site selection and layout of the Ningbo Academy. Some colleges, such as Ferdinand College and Trinity College, etc. These academies were mainly invested and built by Western missionaries or foreigners. In terms of location selection, they emphasized convenient transportation and proximity to economic centers, mostly in areas where foreigners' activities were concentrated. Feidi College was adjacent to Taikoo Wharf and located in the Bund area with frequent economic activities. Trinity College was located at Guanqiaotou, in the center of the city. The convenient geographical locations not only promoted cross-cultural exchanges, It also provided students with more opportunities for social practice, promoted the rise of modern industrialists in Ningbo, and accelerated social development and transformation.

Looking at all periods, the site selection of Ningbo Academy gardens has always been closely related to social culture, educational needs and economic environment, reflecting the changes and adaptations of academy development in different historical stages.

3.2. Spatial Layout of Ningbo Academy Gardens

The Book of Rites: The Book of Music states: "Music is the same, while rites are different." When there is harmony, there is mutual affection; when there is disagreement, there is mutual respect. This concept is vividly reflected in the Ningbo Academy Garden. Compared with the academies built under the supervision of the government, the layouts of the academies privately founded by scholars and literati were more flexible and diverse. They would adjust the courtyard Spaces according to local conditions to form a varied pattern. For instance, the overall layout of Yongshang Witness Academy adopts a symmetrical central axis. The archway-style gate, lecture hall and rear hall are arranged along the axis, reflecting the Confucian view of order(Figure 2). However, its layout is not rigid but combines with the natural environment, presenting a less restrictive manifestation of "joy", thereby achieving the integration of order and freedom.

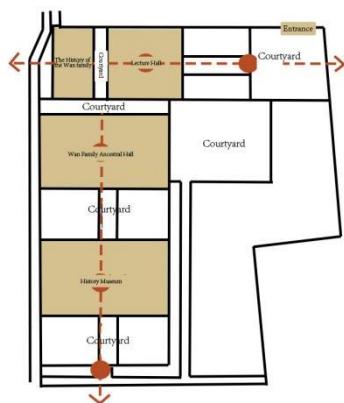

Figure 2 Spatial Plan of Yongshang Witness Academy

Furthermore, the "garden plots" within the academy's walls further enrich the expression of this spatial layout. The garden is usually located at the end of the axis of the academy building or on one side parallel to the axis, adjacent to the lecture hall or dormitory. Although the area is not large, the builders have created a landscape with distinct layers by using techniques such as planting flowers, trees, diverting water and shaping the mountains, endowing the garden with a unique artistic conception. This not only reflects respect for nature and aesthetic pursuit, but also adds a dynamic atmosphere to the rigorous academy environment, further demonstrating the concept of harmony

between "music" and nature.

The design of the academy garden is in line with the courtyard layout of traditional Ningbo residences. The garden in the academy elevates this concept, integrating the academic space with the natural space and blending the academic space with nature. At the same time, the layout design of the academy is also influenced by traditional Jiangnan residences. The Yongshang Witness Academy adopts a courtyard and patio layout, with the courtyard and the patio interpenetrating each other, enhancing the sense of layering. This design is also seen in Yuehu Academy and Cihu Academy. It not only continues the functional and aesthetic characteristics of the residential buildings but also enhances the spatial expressiveness of the academy gardens.

4. Design techniques

4.1. Garden Architecture

The traditional gardens in the Jiangnan region pursue the effect of "though made by man, it seems to have been created by nature". The buildings and landscapes often complement each other, and the scenery changes as one moves. The interior layout and design can not only stand alone as a scene but also coexist harmoniously with the surrounding environment. Influenced by this, the Ningbo Academy Garden features a simple and practical architectural layout, emphasizing harmony with nature. In terms of material selection, fir, pine, plum garden stones and blue bricks are often used, which not only adapt to the local climate but also enhance the overall simplicity. Unlike the elaborately carved white walls and black tiles in the gardens of the Jiangnan region, the Ningbo Academy Gardens extensively use local blue bricks to build their facades, echoing the traditional local residences and presenting a simple and elegant sense of layering. Take the Yongshang Witness Academy as an example. The design of its blue brick exterior walls not only creates a serene atmosphere but also enhances the academy's simple style, forming a sharp contrast with the elegant and refined style of Jiangnan gardens.

In terms of decoration and carving, the Ningbo Academy Garden pursues a scholarly atmosphere, being simple and elegant. Wood carvings are often seen on beams, lintels, doors and Windows, and the contents are usually literary themes such as plum blossoms, orchids, bamboo and chrysanthemums. Stone carvings are mostly used in architectural ornaments, featuring auspicious and lively patterns such as cranes and lions. Brick carvings are widely used as exterior eave decorations in local residences in Ningbo. Besides being applied to the roof ridges and under the eaves, they can also be seen on the gable walls and mountain faces in academies and gardens, presenting vivid and auspicious images of dragons and phoenixes soaring through the clouds. This reflects the close integration of Confucianism and folk culture, creating a solemn and simple architectural style.

During the late Qing Dynasty, influenced by maritime trade and the "eastward spread of Western wind", many academies established by foreign missionaries emerged in the Ningbo area, and garden buildings with Western style elements also began to appear in the academy gardens. For instance, the doors and Windows of the Trinity Academy adopt the semi-circular and square designs commonly found in Western churches, with simple lines. This enhances the artistic sense of the architecture of the Ningbo Academy garden and presents a rich and diverse appearance

4.2. Plant Landscape

Ningbo is located in the subtropical monsoon climate, with a rich variety of vegetation that remains green all year round. The environmental maps of Moon Lake Academy and Yongshang Witness Academy show the extensive use of native plants such as bamboo, cypress, osmanthus, pine and willow in the garden design of the academies to achieve a natural integration of the garden landscape.

At the same time, the plant configuration of the Ningbo Academy Garden also pays attention to the sense of layering and spatial design. When Wan Bangfu once lived in the Ningbo Witness Academy, he wrote, "The pine and cypress trees are planted all over, the shadows of the sun are uneven, the sounds of birds rise and fall, the bamboo shadows sway in the wind, and the lotus flowers are fragrant. The scenery is truly secluded and beautiful." Tall trees such as pines, bamboo and cypresses, combined with low shrubs and ground cover plants, form a multi-level plant landscape. The arrangement of bamboo and cypresses stretches the field of vision and increases the depth of the space, while low flowers and trees like lotus or yellow chrysanthemums create a colorful and natural visual effect, taking into account both aesthetic needs and spatial experience, and making the academy garden more serene and elegant(Figure 3).

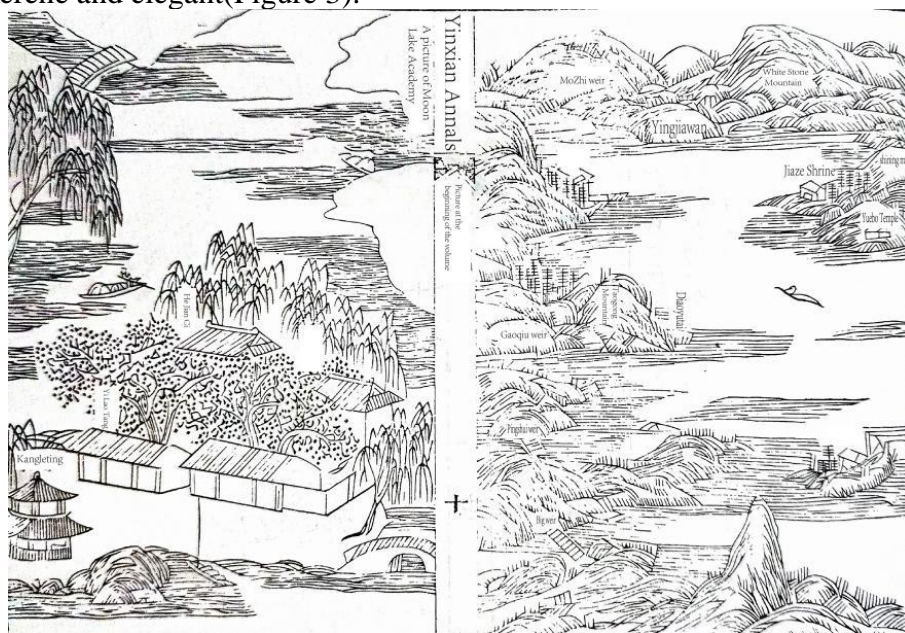

Figure 3 Environmental Map of Moon Lake Academy

The plant selection in Ningbo Academy Gardens also takes into account the changes of the four seasons' landscapes, emphasizing the creation of diverse viewing experiences. There are peaches, plums and bamboo in spring. In summer, there are banana plants, sweet potatoes and osmanthus. There are chrysanthemums and maple trees in autumn. In winter, plants such as pines and cypresses form a dynamic landscape that offers views throughout the year. Such a design keeps the academy garden always full of vitality and conforms to the literati's aesthetic pursuit of "the passage of time and the change of seasons".

The selection of plants not only takes into account aesthetic and ecological effects, but also incorporates profound cultural implications. The couplet of Yongshang Witness Academy reads: "The water marks still remember the old pond, and the path turns to temporarily add new bamboo and cypress." It is a portrayal of the cultural connotation of plants, embodying the elegance and refinement symbolized by bamboo and the longevity and tenacity symbolized by cypress. Yuan Jue also wrote a poem at Jupao Academy, saying: "The Qingmin family had a lecture hall, and in front of it, chrysanthemums were left all over the slope, yellow. ". Chrysanthemums symbolize seclusion and purity, which is in line with the educational tenet of the academy and creates an elegant atmosphere. In addition, among the over 20 cypress trees that Fang Xiaoru planted at the Shijing Monastery in his time, five still remain today. Their trunks, weathered and weathered, symbolize the perseverance of scholars and the enduring vitality of the academy culture.

4.3. Stacking stones to manage water

The water management design of Ningbo Academy Garden not only pursues the beauty of nature, but also carries profound cultural and practical functions. Influenced by traditional Chinese feng shui concepts, academy gardens focus on integrating with water and emphasize that "having water is the best". On the one hand, Ningbo is located on the southeast coast and has a well-developed water system. On the other hand, most academies are relatively small in scale and have a high building density. To expand the spatial hierarchy and enhance the artistic conception of the landscape. Therefore, most of the academies in Ningbo choose to be built along the water, taking advantage of the natural water system to form borrowed scenery or creating a water-friendly environment by introducing water into the gardens. Moon Lake has been a cultural center since the Song Dynasty. There are many academies around it, such as Moon Lake Academy, Bi Zhi Academy, etc. The lake resources are fully utilized to form a unique garden pattern. Meanwhile, the water features of the academy often incorporate cultural elements such as couplets and poetry, endowing them with cultural symbolic meanings. For instance, the "Longquan" well of Longshan Academy is not only a water source but also embodies the literati's pursuit of moral cultivation through the image of "flowing dragon ripples".

The practical function of the water management design in Ningbo Academy gardens is reflected in the fire prevention function. Ningbo has long been renowned for its reputation as "a place that houses books from ancient times to the present and a port that connects the world". As a significant cultural hub, academies not only serve as venues for teaching but also play a crucial role in storing books. For example, during the Southern Song Dynasty, Ying Bozhen of Yinxian had his Hua Ya academy, which collected 5,000 volumes of books. During the Ming Dynasty, Huang Runyu's Nanshan Academy, in addition to collecting books and teaching, also held gatherings of calligraphy and painting. Therefore, the small size and large collection of books in the academy make its fire prevention needs particularly urgent. The water bodies (such as ponds, streams and Wells) in the academy garden are often ingeniously arranged among the buildings, forming natural firebreaks. This not only enriches the spatial layers but also enhances safety. Although Tianyi Pavilion does not fall within the category of academies, as a typical building for storing books, its way of managing water also provides a basis for speculation about academy gardens. For instance, Fan Qin deliberately introduced water from the Moon Lake from the northeast to surround the building and stored water on the south side to form Tianyi Pool, using the water feature to isolate and protect the building. It can be speculated that the academy gardens of the same period might have adopted a similar approach, enhancing their fire prevention capabilities by rationally configuring water bodies. In addition, water bodies combined with moist vegetation (such as bamboo forests and lotus ponds) form a moist micro-environment, which helps to reduce the risk of fire. This multi-functional water management design not only enhances the safety of the academy but also achieves a high degree of unity between the ornamental value and practicality of the garden.

In the Ningbo Academy Garden, stacked stones are one of the key design elements. Yang Taiheng of the Qing Dynasty once composed "Cihu Jiangshe Friends Inviting Drinks" at Derun Academy in Cixi. In the poem, he mentioned: "I wish to visit the stones of Taihu Lake and pass by the Floating Green Pavilion." In the "Picture of Derun Academy", it is also shown that some rockeries are scattered in the garden, with green bamboo placed against the walls. Like other gardens during the Ming and Qing dynasties, the Ningbo Academy gardens generally adopted the "Nine Lions and One Elephant" rockery technique (as shown by the existing rockeries in the Lin Residence and Tianyi Pavilion). When it comes to the selection of stones, precious stones such as Taihu stones and Lingbi stones are relatively expensive and have high transportation costs. Most of the Ningbo Academy gardens prefer to use local materials, making use of local resources to reduce costs and enhance regional

characteristics. Meiyuan stones and mountain miscellaneous stones are widely used. Ningbo is located along the coast and is prone to typhoons. The sea rocks it is rich in are the top choice. The sea reefs, due to the long-term erosion of seawater, have unique cave and pore structures. Combined with other rocks, plants and water bodies, they not only enhance the layering of the landscape but also create a spacious coastal landscape, showcasing a rich Marine cultural atmosphere.

The water management design of Ningbo Academy Garden combines cultural symbolism, spatial optimization and security guarantee functions. It is built along the water, conforms to the regional characteristics, endows the landscape with cultural imagery, and plays an important role in fire prevention and isolation. Meanwhile, the application of stone water bodies in accordance with local conditions not only reduces the cost of garden construction but also shapes a unique local landscape.

4.4. Artistic Conception Creation

The artistic conception of the Ningbo Academy Garden is deeply influenced by Confucianism. As a place for scholars to study quietly and delve into academic research, the academy garden is not only a display of natural space but also an expression of the inner world of the literati. Throughout history, scholars have integrated their personal emotions and life experiences into gardens through cultural symbols such as poetry and couplets, creating rich cultural artistic conceptions. As the saying goes, "The scene evokes emotions." The creation of a garden's artistic conception is a process of expressing emotions through natural scenery. Every flower, every blade of grass, every piece of water and every stone in the garden can serve as a medium for expressing emotions.

For instance, Li Tang once wrote in "Donghu Academy" : "Donghu Academy is free of smoke and smoke, and the reputation of scholars and scholars remains unwavering." With the same spirit as Yao, there is no need to have descendants all over the mountains. Express pride and commitment to learning and family traditions through the academy environment. Quan Zuwang wrote in "Chen Shilang's Lecture on the House" : "Now the offspring have scattered, only the double eaves remain. The three lecture halls are empty, overgrown with lush grass." It is through the desolate environment of the academy that one expresses their nostalgia for the good old days of the academy.

In the gardens of Ningbo Academy, couplets and plaques add cultural layers to the creation of the artistic conception. For instance, the couplet of Longshan Academy reads: "Wise water quenches the fire of the heart, benevolent wind sweeps away the dust of the world." It expresses the self-cultivation and moral education of benevolence in Confucianism. Hu Yuanjie of the Qing Dynasty wrote in Mao Mountain Academy: "Having seen five hundred years of dust, trees and people, fortunately this day to find the falling mood; Though not a thousand grand mansions, with each string and each chant, may all beings live up to the mountain of fame. He has even integrated his dedication to cultural inheritance and passion for education into the space of the academy garden.

The garden of Ningbo Academy also emphasizes the integration of natural and artificial landscapes. The interaction between water features and artificial structures (such as pavilions, terraces, rockeries, and stone Bridges) also creates the artistic conception of the academy garden. For instance, the setting of stone Bridges and pavilions in Yuehu Academy and Taoyuan Academy, as well as the changing views of Taihu Stone and Fubi Pavilion in Cihu Academy, All of them have become a wonderful way for the people of the academy to express their aspirations and feelings.

The poems and couplets in the academy garden demonstrate the unique aesthetic perspectives of scholars and refined people, enhancing the cultural atmosphere of the garden. They complement the natural landscape, forming a garden space full of poetry and philosophy, and have become an ideal environment for scholars to cultivate themselves and pursue their studies.

5. Conclusion

The Ningbo area is a famous historical and cultural city in China. It attaches great importance to education and learning, has a flourishing literary atmosphere, and has always produced a large number of talents. The development of the academy garden is at the forefront of the province and is a precious asset of Ningbo's historical culture and gardens. This article, through the study of the garden-making techniques and cultural images under its historical accumulation, reveals the value of academy gardens in conveying the spirit of scholars, shaping the atmosphere of the place, and promoting the integration of the environment and humanity. It is of great practical significance for protecting and developing the garden resources in Ningbo and inheriting their spiritual and cultural connotations.

Acknowledgements

General Research Project of Zhejiang Provincial Department of Education: "Research on the Changes of Ningbo Gardens during the Ming and Qing Dynasties" (NO. Y202146967).

References

- [1] Fu J, Tang X. *Naturalistic, Harmonious, and Emotional: An Aesthetic Study of Plants of Chinese Gardens in the Qing Dynasty*[J]. *J. Lit. Art Stud*, 2019, 9: 1326-1332.
- [2] Li W. *Gardens and illusions from late Ming to early Qing*[J]. *Harvard Journal of Asiatic Studies*, 2012, 72(2): 295-336.
- [3] Yu J, Yokota T, Itami E, et al. *Correlations between spatial attributes and visitor stay in Chinese gardens: a case study of the Ningbo Tianyige Museum Gardens*[J]. *Urban Science*, 2021, 5(4): 74.
- [4] Clunas C. *Fruitful sites: garden culture in Ming dynasty China*[M]. Duke University Press, 1996.
- [5] Keswick M. *The Chinese garden: History, art, and architecture*[M]. Harvard University Press, 2003.
- [6] Stuart J. *Ming dynasty gardens reconstructed in words and images*[J]. *The Journal of Garden History*, 1990, 10(3): 162-172.
- [7] Yanlin Z. *Study on the Art of Stone Piling in Jiangnan Gardens under the Influence of Taoist Aesthetic Thought in Ming and Qing Dynasties*[J]. *Journal of Landscape Research*, 2020, 12(5): 83-86.
- [8] Zheng J. *Art and the shift in garden culture in the Jiangnan Area in China (16th-17th Century)*[J]. *Asian Culture and History*, 2013, 5(2): 1.
- [9] Clunas C. *Ideal and reality in the Ming garden*[C]//*The Authentic Garden: A Symposium on Gardens*, edited by Leslie Tjon Sie Fat and Erik de Jong. 1991: 197-207.
- [10] Yang H. *A Treatise on the Garden of Jiangnan: A study on the Art of Chinese Classical Garden*[M]. Springer Nature, 2022.